

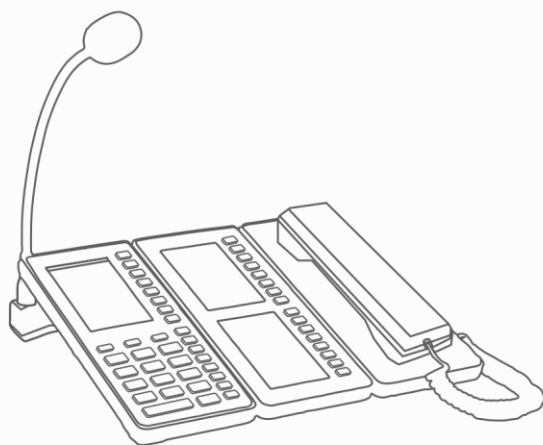

# IP PAGING MICROPHONE

## Installation Instructions



### Interface Specification

#### 1.IP PAGING MICROPHONE

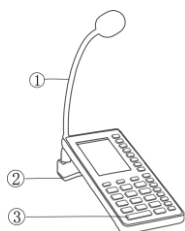

① Microphone pole

② Loudspeaker

③ Keyboard

Mutual input channel, accept Command input.

#### 2.Expansion panel (optional configuration)

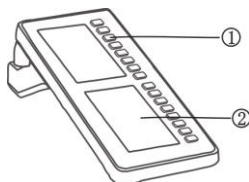

① Key

② Display screen

True color display screen indicate complete machine login status, volume value, partition list and other relevant information.

#### 3.Receiver panel (optional configuration)

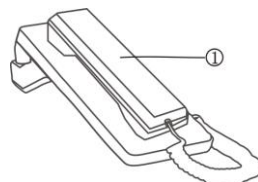

① Receiver

Built-in loud speaker and microphone. Restore the remote voice and set the scene voice.

### Back

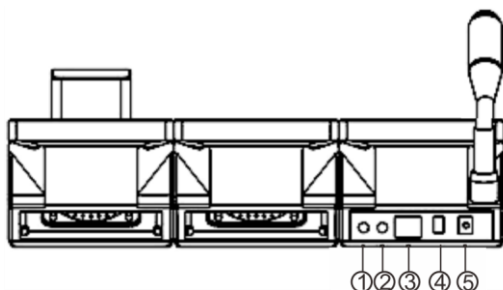

① Audio input interface: connect with earphone or other 3.5mm audio plug.

② Audio output interface: The interface of the output is the original audio signal. Can be used as a source of sound to the amplifier or active loudspeakers, and background music playing, the factory setting is audio output.

③ Ethernet interface: use the cable to connect the server and terminal.

④ Alarm output interface

⑤ Power input interface: connect 12V DC power.

### Connection Diagram

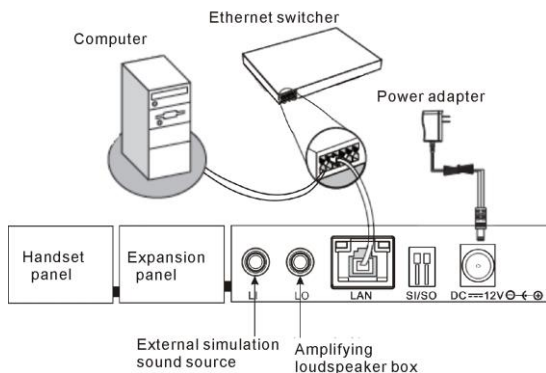

### Appearance installation dimension drawing (Units: mm)

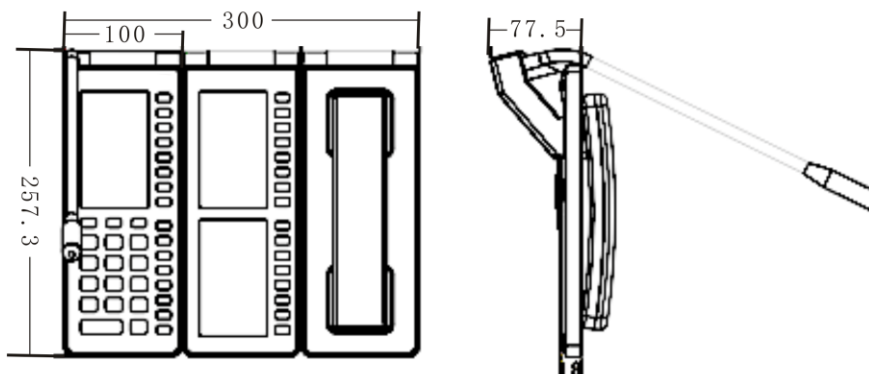

### Microphone pole installation method

(1) Microphone pole groove install

Accordance with the pedestal raised groove.

(2) Screwing the rotary knob tightly according to the direction of graphic.

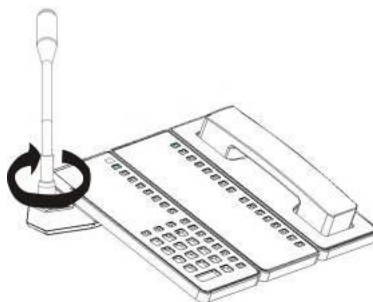
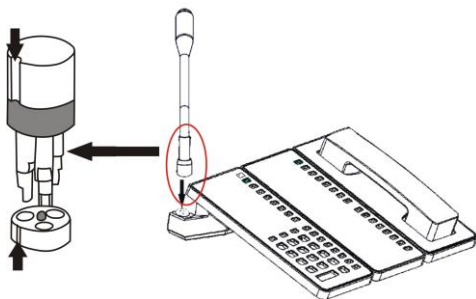

**Remark: expansion panel and receiver panel is optional configuration.**

### IP Paging Microphone Setting

#### Liquid crystal display setting

Press **【information】** key, enter password **【123456】** could into the system setting interface, press **◀, ▶** button to move, press numeric keys to modify equipment ID, IP address, server IP and other parameters, then press **□** button to save. (Note: ID and IP can not be same as other terminal or mainframe.)

#### Visit web interface

- (1) Please enter the terminal address in browser, then press enter.
- (2) Enter the user name and password in Web login window (the default is : admin, password : Rdc070#\*), click OK.

## Specifications, Functional Unit and Parameters

Power supply & Power consumption	DC12V 2A, ≤10W
Functional unit interface	Alarm in or alarm out: 1pc, Voice frequency input port: 1pc, Voice frequency output port: 1pc, Power input port: 1pc, RJ45 network port: 1pc, SD card port: 1pc
Network communication protocol	TCP/IP、UDP、ARP、ICMP、IGMP、HTTP、FTP
Built-in amplifier power	3W
S/N & Frequency response	>90dB, 20Hz-20KHz
Display screen	TFT 4.3"LCD(480x272)
Network chip rate	10/100Mbps Self-adaption
Voice frequency encoding	MP2、MP3、PCM、ADPCM
Audio sampling & Bit rate	8K~44.1KHz,16bit, 8kbps-320kbps
Working temp& Humidity	-10℃~55℃, ≤90%RH (Not condensing)
Dimensions & Weight	300x257.3x77.5mm, 2.3kg

## Trouble shooting

Fault Phenomenon	Failure Cause and Trouble Removal
Terminal can not login to the server, intercom and broadcast is not normal?	1.Check the bandwidth is limited or not( use the network bandwidth tools to test it), it should broaden the bandwidth if it's limited. 2.Detected a lot of data flow of bandwidth, please restrict this IP address. 3.Checking the ID number and host IP address is conflict or not, please reset the ID number or host IP address if it's conflict. 4.If ID number and IP address is not conflict, but it can not make normal conversation, please acquire the data package and submit to the factory for analyzing.
Web abnormal	Empty the cache or modify the browser.

## Packing list



Power adapter  
(DC12V/2A) 1pcs



Installation  
instructions 1pcs



Microphone  
pole 1pcs



Certification 1pcs



Wechat

SPON Communication Technology Co., Ltd.  
www.spon.com.cn  
Service Hotline: +86-400-823-2588  
Reserve the amendment right without notice

